

Albert Edward Watts

was born on October 4th 1890 in 59 St Margaret's Grove, East Twickenham. He was the third of seven children born to George Watts and Louisa Watts, nee Lemon. His siblings were: Louisa born 1886, George born 1887, Sidney born 1892, Beatrice born 1895 Ethel born 1897 and Charles born 1900. Albert was baptised on January 18th 1891, St Stephens Church, East Twickenham. His place of birth was 59 St Margarets Grove, St Margarets, Twickenham.

George senior was a carpenter and joined born in Enfield, his wife Louisa was born in Kent. The family moved from East Twickenham to Isleworth around 1896, living first at Walkers Cottages and then in 1911 to Rose Cottages in Worton Road, Isleworth.

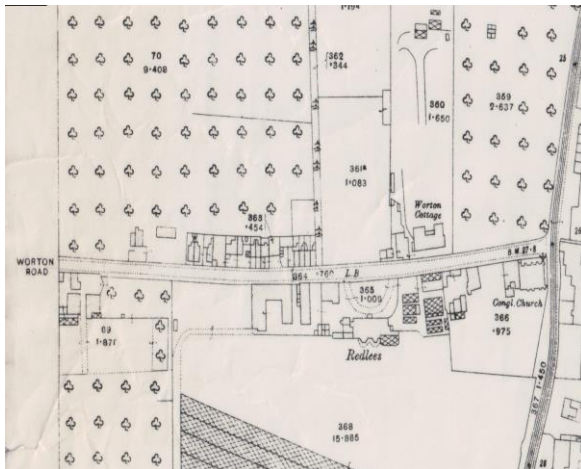

Worton Road, at its junction with Twickenham Rd, Isleworth. Rose Cottages were opposite Redlees, C1915 Ordnance Survey Map

Albert attended Isleworth County School that later became Isleworth and Syon School, and on leaving his school, went to work for the National Physical Laboratory as a laboratory assistant. He enlisted in the King's Own Yorkshire Light Infantry and

became a temporary second lieutenant. He married Dorothy Ellen Savage at St Mary the Virgin, Twickenham on 22nd April 1916.



British troops advancing in support during the Battle of Morval, Somme: 25th September 1916. Imperial War Museums, Collection no 1900-09

He was killed in action on 25th September 1916 at Gueudecourt, in the Battle of Morval. His name is inscribed on the Thiepval Memorial. He is also recorded on the memorial in All Souls Church, Northcote Road.

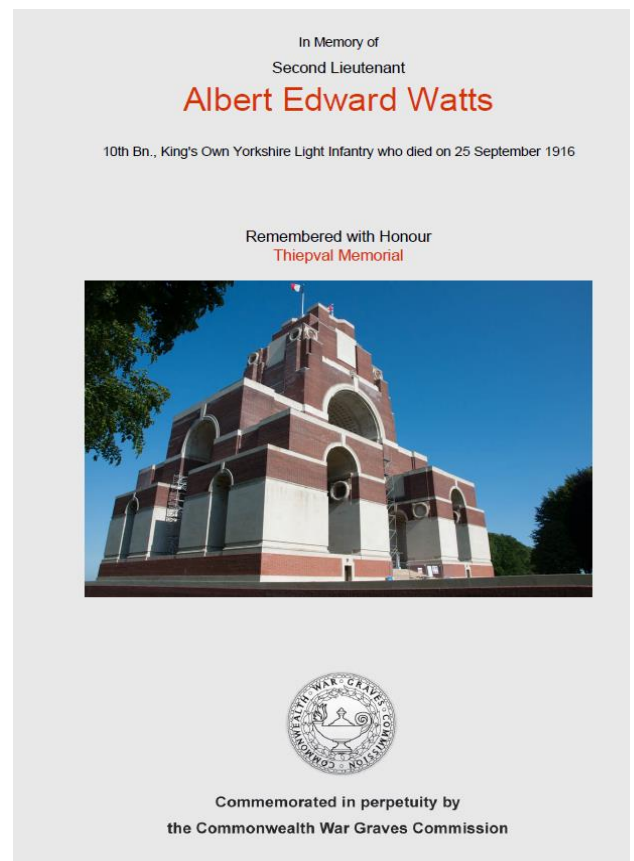

Certificate included with the permission of the CWGC